

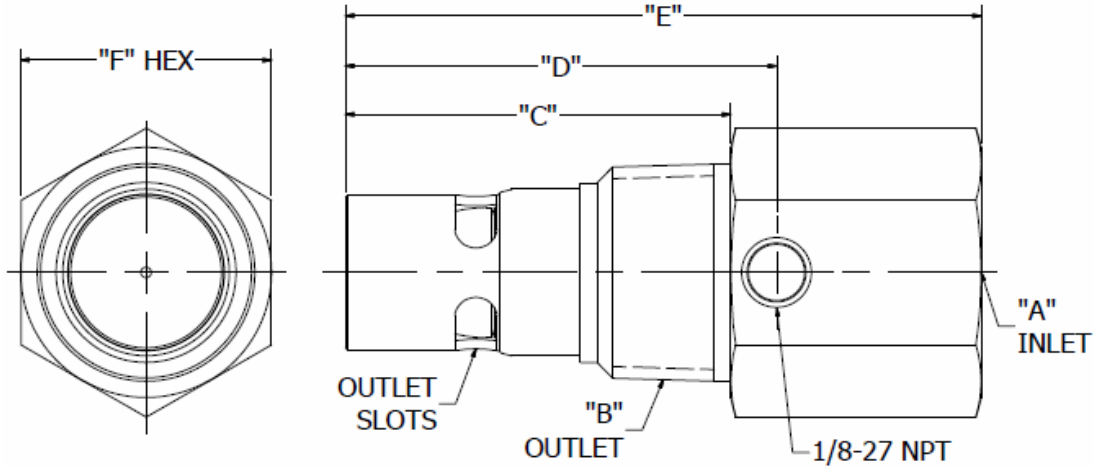

**In-Tank Check Valve
Model: CTB-Series**



Max Operating Pressure: 500 psig

Operating Temperature Range: -65° to 450°F

Available Flow Capacities: 15 to 95 SCFM

Available Inlet Connection Sizes: 1/4" to 1-1/2" (-4 to -24)

Inlet Connection Type: Female NPT

Available Outlet Connection Sizes: 3/8" to 1-1/2" (-6 to -24)

Outlet Connection Type: Male NPT

Materials of Construction:

Body: Brass

Valve Housing: Brass or Plated Steel

Seal: Reinforced PTFE

Spring: 302 Stainless Steel

| MODEL | "A" (NPT) | "B" (NPT) | "C" (in) | "D" (in) | "E" (in) | "F" (in) | RATED FLOW (SCFM @ 100 psig) | FLOW FACTOR (Cv) |
|-----------|--------------|--------------|-------------|-------------|-------------|----------|---------------------------------------|------------------------|
| CTB3838 | 3/8" | 3/8" | 1.56 | 1.84 | 2.60 | 3/4" | 15 | 1.5 |
| CTB1212 | 1/2" | 1/2" | 1.67 | 1.92 | 2.72 | 15/16" | 20 | 2.3 |
| CTB3434 | 3/4" | 3/4" | 1.93 | 2.18 | 3.18 | 1-3/16" | 30 | 3.9 |
| CTB11 | 1" | 1" | 2.31 | 2.58 | 3.81 | 1-1/2" | 60 | 6.3 |
| CTB114114 | 1-1/4" | 1-1/4" | 2.44 | 2.74 | 4.02 | 1-7/8" | 95 | 13.7 |
| CTB112112 | 1-1/2" | 1-1/2" | 2.31 | 2.61 | 3.35 | 2-1/8" | 95 | 13.7 |

CONRADER

Ordering Information

| CTB | | 12 | 12 | - | P1 | - | NP | - | PLUG | - | SST |
|-----------------------|--|------------------------|----|----------------------|---------|----------------|---------|--------------------|---------|----------------|---------|
| Inlet Connection Size | | Outlet Connection Size | | Additional Side Port | | Plating Option | | Plugged Side Ports | | Thread Sealant | |
| | | | | Option | Code | Option | Code | Option | Code | Option | Code |
| | | | | None | (Blank) | None | (Blank) | Not Plugged | (Blank) | None | (Blank) |
| | | | | 1/8" NPT | P1 | Nickel Plated | NP | Plugged | (Plug) | White | SST |
| | | | | 1/4" NPT | P2 | | | | | | |

Options

1. Inlet Connection Size: The available sizes are 1/4" to 1-1/2".
2. Outlet Connection Size: The available sizes are 3/8" to 1-1/2".
 - Note: Not all inlet/outlet size combinations are available. Call or email to check for availability.
3. Additional Side Port
 - a. 1/8" – Additional 1/8" female NPT side port 180° from existing port.
 - b. 1/4" – Additional 1/4" female NPT side port 180° from existing port.
4. Plating Option
 - a. None
 - b. Nickel Plated – Electroless Nickel Plated Brass
5. Plugged Side Ports
 - a. Not Plugged – Side ports are not plugged.
 - b. Plugged – Side ports are plugged with removable threaded plated steel plugs.
6. Thread Sealant
 - a. White colored thread sealant
 - b. Rust colored thread sealant

Examples:

1. A CTB check valve with a 1/2" NPT inlet connection and 3/4" NPT outlet connection with the side port plugged is **CTB1234-PLUG**.
2. A CTB nickel plated check valve with 1" NPT inlet and outlet connections with an additional 1/4" NPT side port is **CTB11-P2-NP**.