

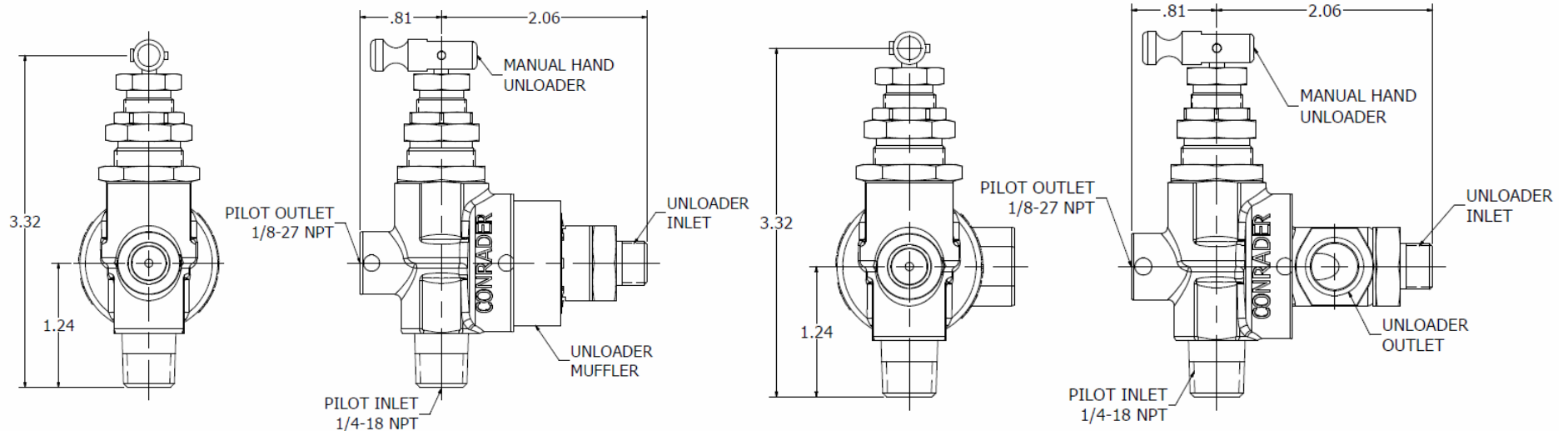

## Piloted Unloader Valve Model: BG-Series



\*Dimensions will vary with different connections and configurations.

### Operating Specifications:

**Unload Set Pressure Range: 40 to 250 psig**

**Set Pressure Differential Range: 10 to 50 psid**

**Operating Temperature Range: -65°F to 400°F**

**Max Flow Capacity: 20 SCFM @ 100 psig**

### Available Connections:

**Unloader Connection Sizes: 1/4" to 3/8" (-4 to -6)**

**Connection Types: NPT, BSPT, Compression**

### Materials of Construction:

**Body/Fittings: Brass**

**O-Rings: Silicone/Viton**

**Poppets: Reinforced PTFE**

**Springs: Stainless Steel**



## Ordering Information

BG		1		-		M		-		HU2		-		SA		-		SST		-		90-120	
Configuration Number		Unloader Outlet Option		Hand Unloader Options		Pilot Tamper Seal		Thread Sealant		Pressure Setting													
See Available Configurations Below		Option	Code	Option	Code	Option	Code	Option	Code	Option	Code												
		Muffler (Standard)	M	Aluminum (Standard)	(Blank)	None	(Blank)	None	(Blank)														
		Diffuser	D	Red Cap	HU2	Sealed	SA	White	SST														
				Black Knob	HU3																		

## Options

1. Configuration: Available configurations are listed on the following pages. If the configuration needed is not listed please contact us at [orders@conrader.com](mailto:orders@conrader.com)
2. Unloader Outlet
  - a. Muffler: The muffler comes standard and reduces the noise from the unloader.
  - b. Diffuser: The diffuser restricts the flow less than the muffler but creates more noise.
3. Hand Unloader Options
  - a. Aluminum: Standard aluminum hand unloader on all valves.
  - b. Red Cap: A red vinyl cap installed on the aluminum hand unloader.
  - c. Black Knob: A plastic black knob in place of the aluminum hand unloader.
4. Pilot Tamper Seal:
  - a. None: A seal will not be applied to the pilot adjustments.
  - b. Sealed: A blue tamper seal will be applied across the pilot adjustments.
5. Thread Sealant:
  - a. None
  - b. White colored thread sealant.
6. Pressure Setting: The desired pilot load and unload pressure settings.

<b>Model</b>	<b><u>Unloader Inlet Connection</u></b>	<b><u>Unloader Outlet Connection</u></b>
<b>BG-1</b>	1/4" (-4) COMPRESSION 7/16-24 UNS-2A	UNLOADER MUFFLER
<b>BG-2</b>	1/4" (-4) FEMALE NPT 1/4-18 NPT	UNLOADER MUFFLER
<b>BG-3</b>	1/2" (-8) COMPRESSION 11/16-20 UN-2A	1/4" (-4) FEMALE NPT 1/4-18 NPT
<b>BG-4</b>	1/4" (-4) FEMALE NPT 1/4-18 NPT	1/4" (-4) FEMALE NPT 1/4-18 NPT
<b>BG-5</b>	3/8" (-6) COMPRESSION 9/16-24 UNF-2A	UNLOADER MUFFLER
<b>BG-6</b>	1/4" (-4) FEMALE BSPT Rc 1/4-19 (BSPT)	UNLOADER MUFFLER