

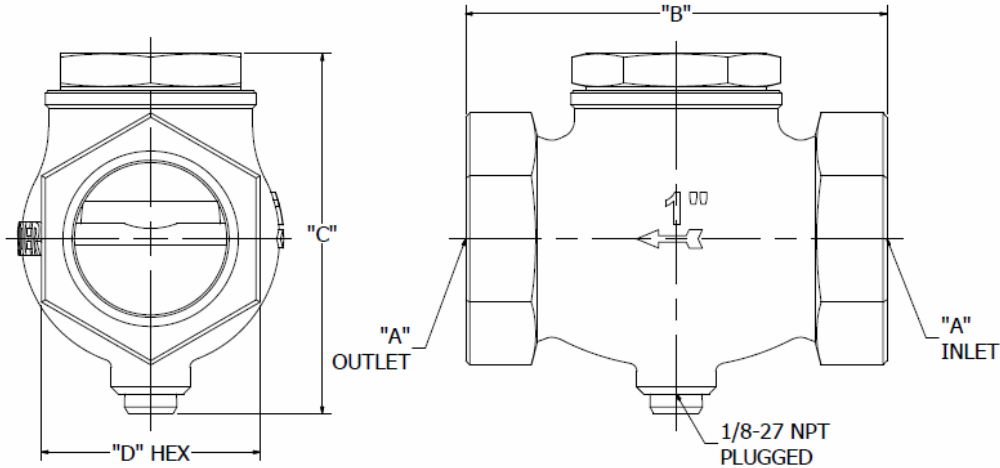

**In-Line Check Valve
Model: GV-Series**



Max Operating Pressure: 250 psig

Operating Temperature Range: -65° to 450°F

Available Flow Capacities: 12 to 220 SCFM

Connection Sizes: 1/8" to 2" (-2 to -32)

Connection Type: Female NPT

Materials of Construction:

Body: Brass

Seal: Reinforced PTFE

Spring: 302 Stainless Steel

MODEL	"A" (NPT)	"B" (in)	"C" (in)	"D" (in)	RATED FLOW (SCFM @ 100 psig)	FLOW FACTOR (Cv)
GV18	1/8"	1.76	1.74	13/16"	12	1.41
GV14	1/4"	1.76	1.74	13/16"	12	1.41
GV38	3/8"	1.85	1.77	15/16"	22	2.59
GV12	1/2"	2.28	2.24	1-1/16"	38	4.15
GV34	3/4"	2.54	2.35	1-5/16"	60	7.33
GV1	1"	3.20	2.73	1-11/16"	115	13.31
GV114	1-1/4"	3.60	3.19	2"	160	23.06
GV112	1-1/2"	3.98	3.42	2-1/4"	160	23.06
GV2	2"	4.91	4.00	2-7/8"	220	57.67

CONRADER

Ordering Information

GV 12 - NP

Connection Size	Plating Option	
	Option	Code
	None	(Blank)
	Nickel Plated	NP

Options

1. Connection Size: The available sizes are 1/8" to 2".
2. Plating Option
 - a. None
 - b. Nickel Plated – Electroless Nickel Plated Brass

Examples:

1. A GV check valve with 1/2" NPT connections is **GV12**.
2. A GV nickel plated check valve with 1" NPT connections is **GV1-NP**.